



Ostertag Vistas

FLOOR PLAN AND CONFIGURATION GUIDE

UPDATED: SEPTEMBER 2009

Summary:

This document is provided to illustrate the overall floor plan of Ostertag Vistas as well as provide sample floor plan options to be used as reference for preparation of your event. Below are guiding principles that will help in the design of your final setup:

- Step #1) Determine the number of guests that will attend your event,
- Step #2) Review sample design options provided in this document,
- Step #3) Review the '*Summary of Tables and Chairs*' section on Page 3 of this document, and
- Step #4) Determine the option that best meets your needs.

You will be asked to define your final setup configuration approximately 30 days prior to your event. Below is additional information pertaining to tables, beverage, cake, and gift areas:

TABLES/CHAIRS:

All tables are 'skirtable' by using various techniques. Some rectangular tables have wider 'lips' than others.

An inventory list of tables (including sizes, quantities, etc) and chairs can be found in the '*Summary of Tables and Chairs*' section on page 3 of this document.

SUGGESTED BEVERAGE AREAS:

Suggested beverage areas include the Milk House (tented bar) and Patio Area (both outside of the main barn facility). Other options include indoor bar locations in the Katoctin Room or kitchen areas.

CAKE LOCATIONS:

Popular cake locations include in front of the fireplace in the Great Room, in the West Mow, and in the Katoctin Room.

GIFT AREAS:

Popular gift areas include the Stable, Rams Den, and the gazebo outside of the barn.



Ostertag Vistas Overall Floor Plan



Milk House

Main Level

Loft/Stage Level

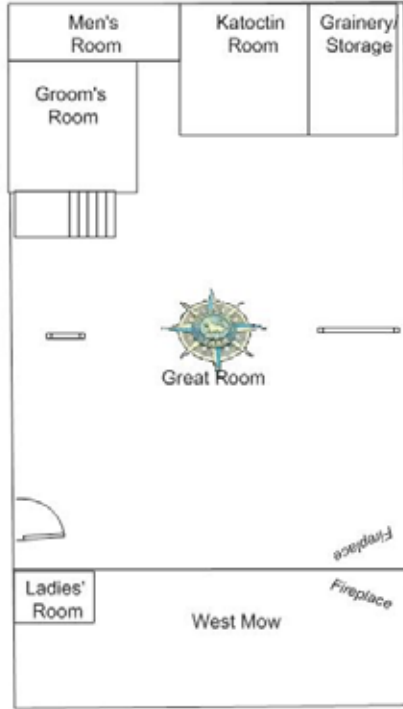
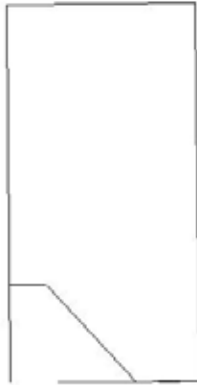

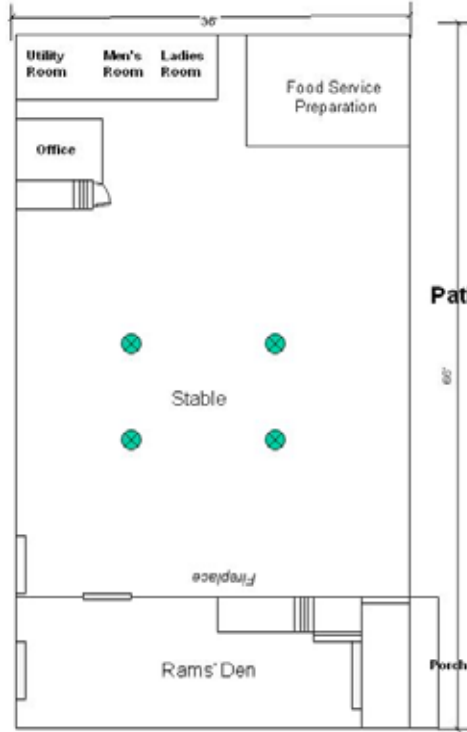

Lower Level

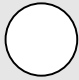

SUMMARY OF TABLES AND CHAIRS AS OF SEPTEMBER, 2009

ROUND TABLES		
		
Quantity	Size	Approximate Seating per Table
2	33" diameter 'Sweetheart'	2
9 + 2 wood tops	48" diameter	4-6
4	42" diameter	5-6
7	39" diameter	4
16	60" diameter	8

RECTANGULAR TABLES		
		
Quantity	Size	Approximate Seating per Table
2	20 x 30" (Unity Candle Table)	Holds Unity Candle, etc.
4	4' long	Various Uses
1	5' long	5-7 (<i>Depending if tables ends are used for seating</i>)
5 + 1 wood top	6' long	6-8 (<i>Depending if tables ends are used for seating</i>)
17 + 6 wood tops	8' long	8-10 (<i>Depending if tables ends are used for seating</i>)

SQUARE TABLES		
		
Quantity	Size	Approximate Seating per Table
16	34"	4

There are also other miscellaneous sized tables that can be used for a variety of purposes.

CHAIRS

400 elegant resin white chairs are available for ceremony and reception seating.

TABLE LINENS

Caterers or clients provide table linens.

**Option 1A:
Main Level:
Great Room
Seating for 90 Guests**

This is a comfortable table configuration for 90 guests using round tables throughout the Great Room. A large head table is placed next to the West Mow to seat 6 guests. Buffet tables can be placed in the West Mow with a beverage table. Cake is placed in Katoctin Room. Additional seating can be accommodated on the loft/stage level and/or lower levels. Hors D'oeuvres are served in the lower level (Reference Options 4B). See other diagrams for information.

- 39" Round Table = 4 People Per Table
- 42" Round Table = 5-6 People Per Table
- 48" Round Table = 6 People Per Table
- 60" Round Table = 8 People Per Table
- 2-8' Rectangular Table = 10 People

Great Room

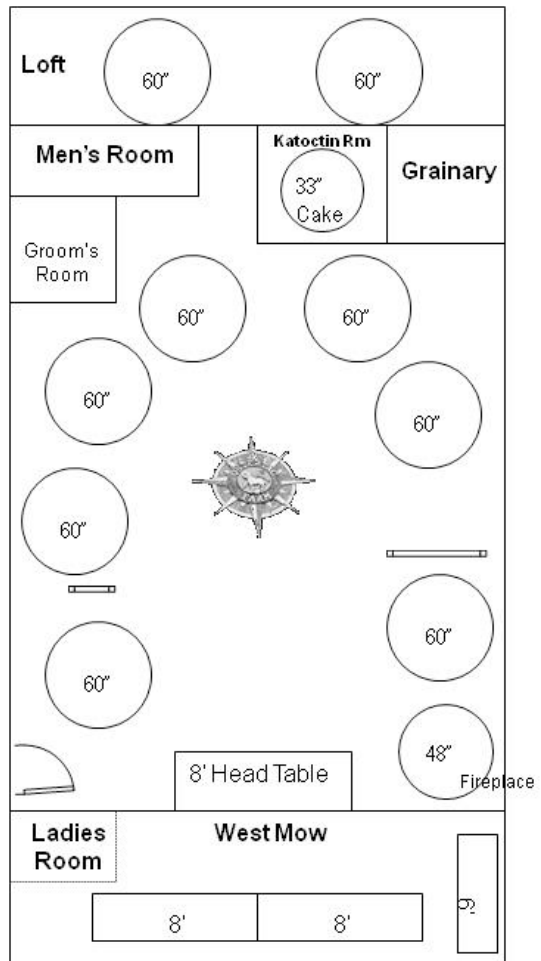

**Option 1B:
Lower Level: Patio Area
Hor D'oeuvres**

LowerLevel

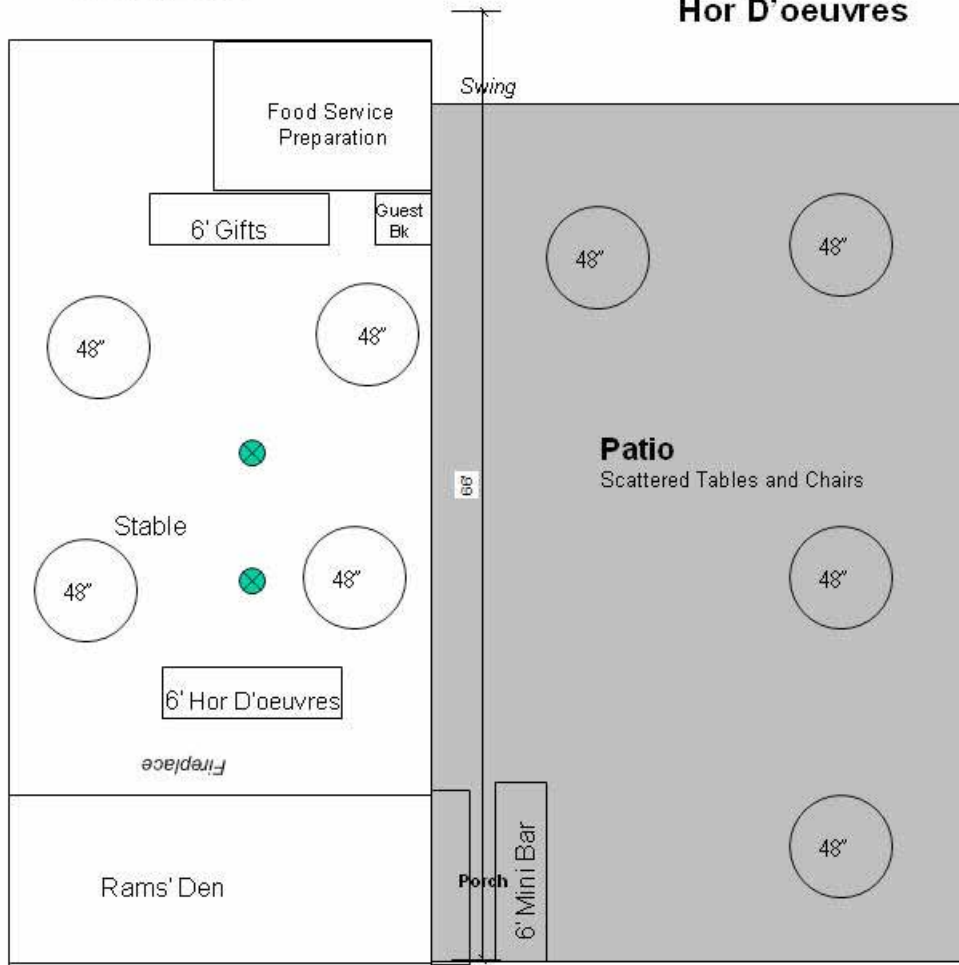

Optional outdoor seating can hold guests by using round tables. This is a popular option as it accommodates both outdoor and indoor conditions and informal traffic flow for conversation. Tents can be used depending on preference and conditions.

48"

**Option 2A:
Main Level:
Great Room
Seating for 120 Guests**

This is a comfortable table configuration for 120 guests using round tables throughout the Great Room, Loft, and Katoctin Room. A large head table is placed next to the West Mow to seat 14 guests. Buffet tables are placed in the West Mow with a beverage table. Cake is placed next to the fireplace. Hor D'oeuvres are served in the lower level (Reference Options 2B). See other diagrams for information. Diagram not to scale.

- 39" Round Table = 4 People Per Table
- 42" Round Table = 5-6 People Per Table
- 48" Round Table = 6 People Per Table
- 60" Round Table = 8 People Per Table
- 2-8' Rectangular Table = 10 People

Great Room

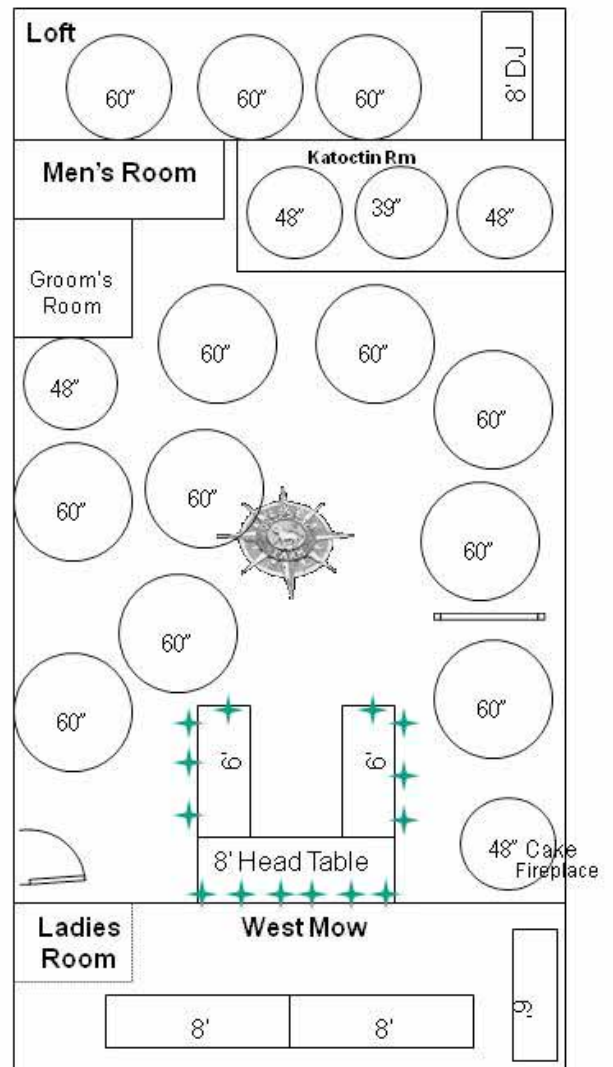

**Option 2B:
Lower Level: Patio Area
Hor D'oeuvres**

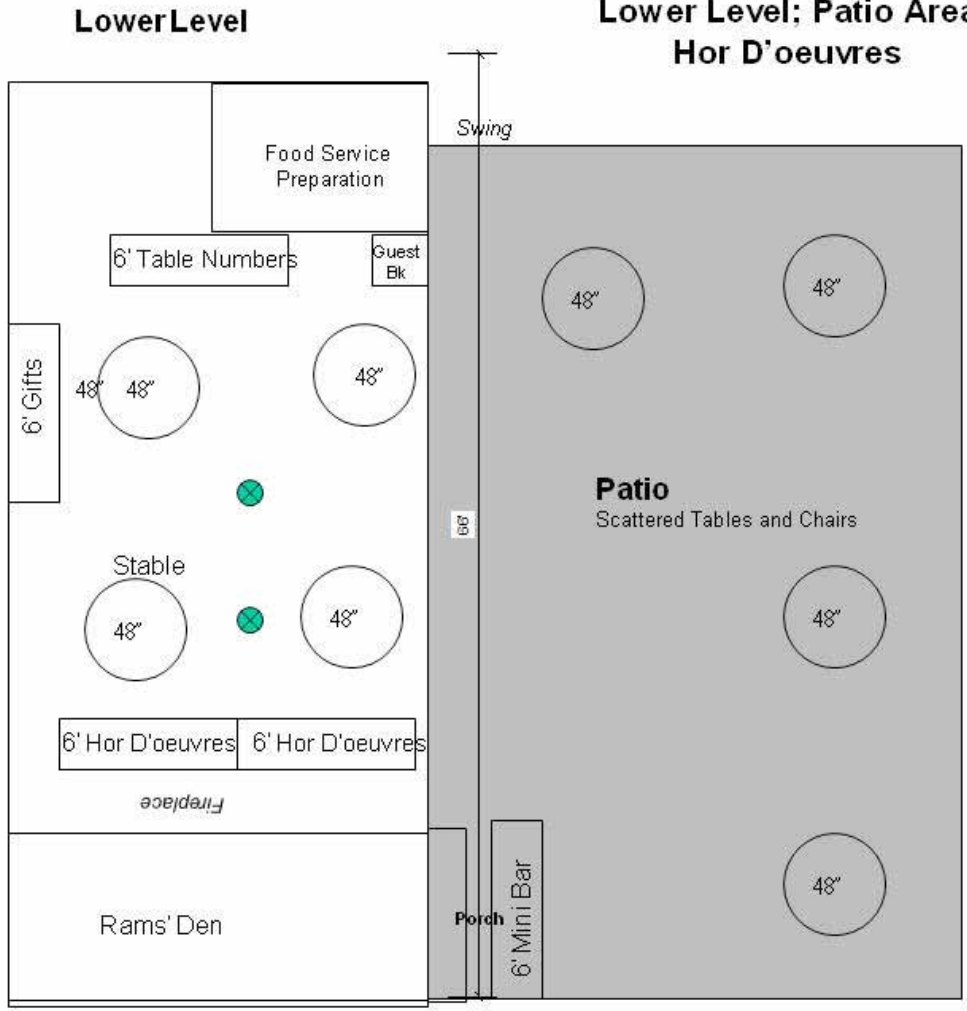

Optional outdoor seating can hold guests by using round tables. This is a popular option as it accommodates both outdoor and indoor conditions and informal traffic flow for conversation. Tents can be used depending on preference and conditions.

48"

**Option 3A:
Main Level:
Great Room
Seating for 120 Guests**

This is a comfortable table configuration for 120 guests using round tables throughout the Great Room, Loft, and Katoctin Room. A head table is comprised of one sweetheart table for the bride and groom and flanked with two 48" round tables for the bridal party. Buffet tables are placed in the West Mow with a beverage table. Cake is placed next to the fireplace. There is a tented bar in front of the milk house at this level. Hors D'oeuvres are served in the lower level (Reference Options 3B). See other diagrams for information. Diagram not to scale.

- 39" Round Table = 4 People Per Table
- 42" Round Table = 5-6 People Per Table
- 48" Round Table = 6 People Per Table
- 60" Round Table = 8 People Per Table
- 2-8' Rectangular Table = 10 People

Great Room

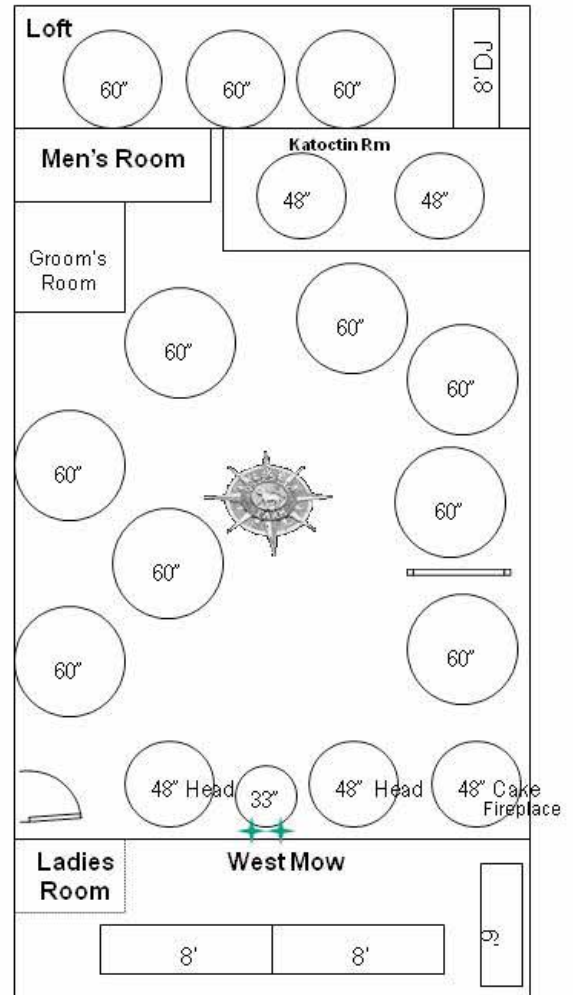

**Option 3B:
Lower Level; Patio Area
Hor D'oeuvres**

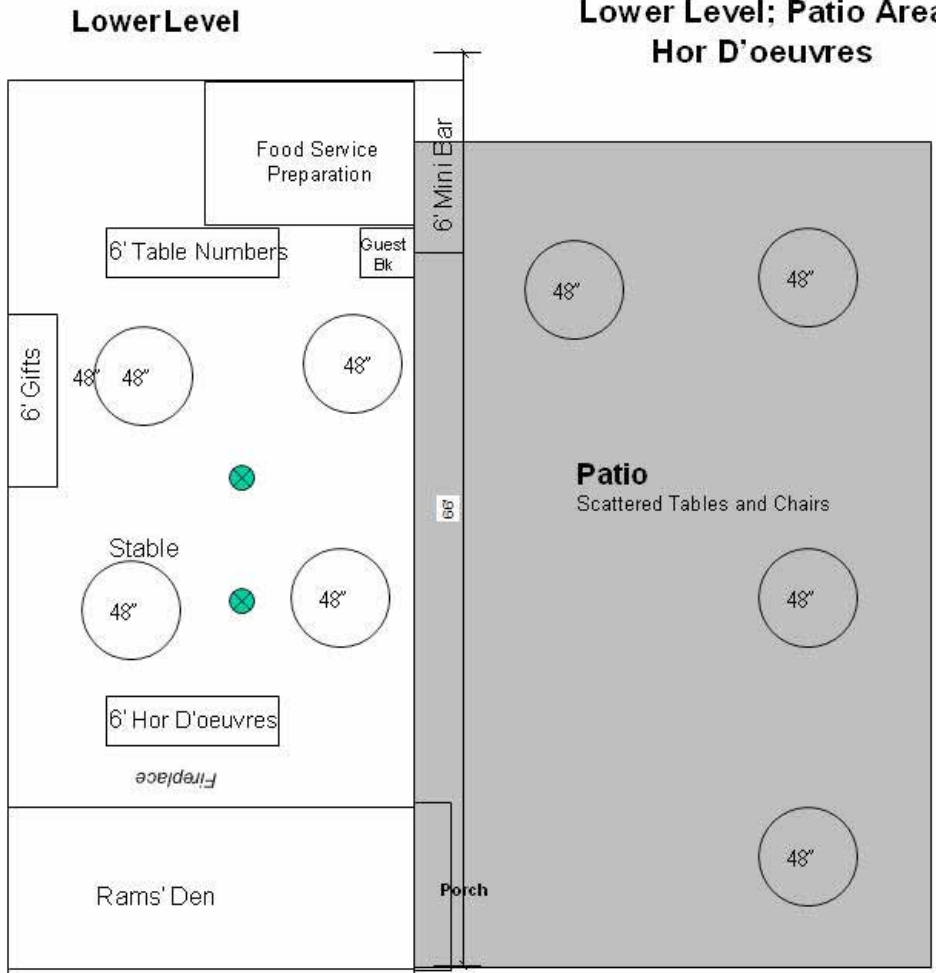

Optional outdoor seating can hold guests by using round tables. This is a popular option as it accommodates both outdoor and indoor conditions and informal traffic flow for conversation. A mini bar for Hor D'oeuvres here is placed on the porch next to the food service preparation area. Tents can be used depending on preference and conditions.

48"



Option 4 174 Guests

Main Level

Lower Level



Milk House

8' Mini Bar

Loft/Stage Level

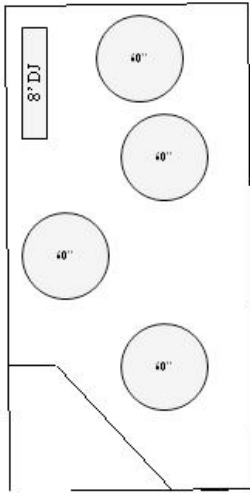

8' DJ

40"

40"

40"

40"

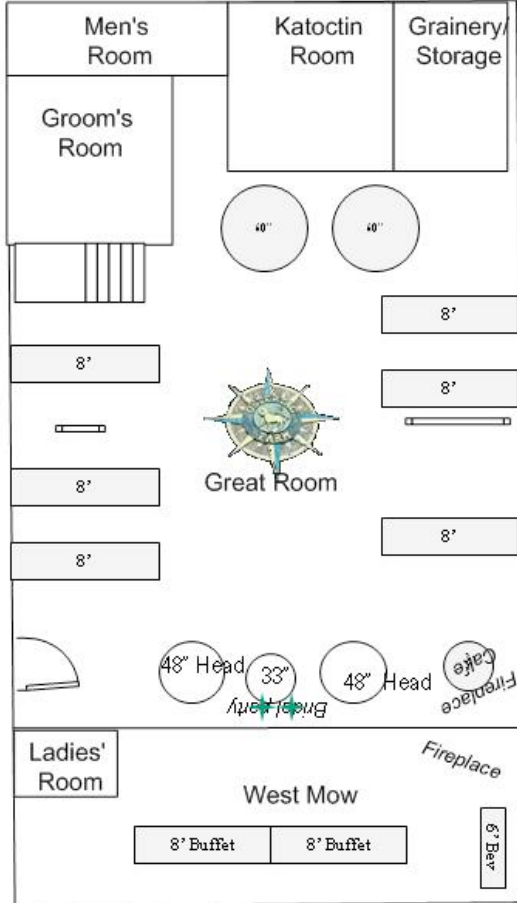

Men's Room

Katoclin Room

Grainery/Storage

Groom's Room

40"

40"



Great Room

8'

8'

8'

8'

48" Head

33"

48" Head

Cake

Ladies' Room

West Mow

8' Buffet

8' Buffet

6' Bar

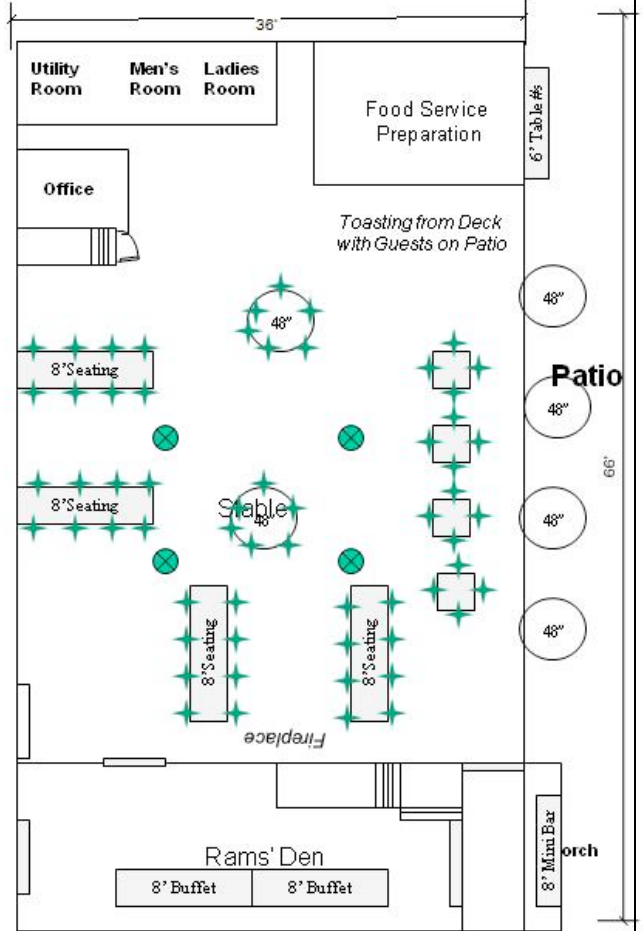

Utility Room

Men's Room

Ladies' Room

Food Service Preparation

Office

Toasting from Deck with Guests on Patio

48"

8' Seating

8' Seating

Stable

8' Seating

8' Seating

Fireplace

Rams' Den

8' Buffet

8' Buffet

8' Mini Bar

orch

Patio

48"

48"

48"

48"

48"

48"

48"

48"

48"

48"

48"

48"

48"

48"

48"

48"

48"

48"

48"

48"

48"

48"

48"

48"

48"

48"

48"

48"

48"

48"

48"

48"